

Direct Illumination

IDD SERIES - Direct Dome light illumination

LED is mounted inside a dome, strong irradiation can be made at whole angles and extreme bright light.

Application: SMD LED inspection, SMD resistor, Crack and chip.

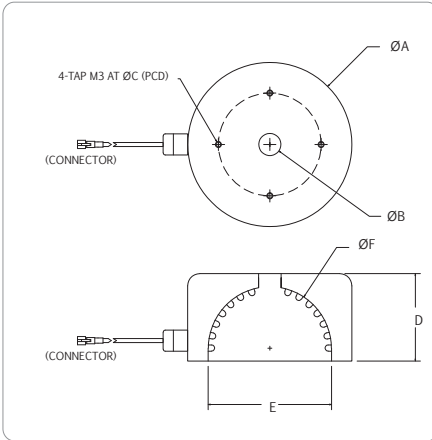
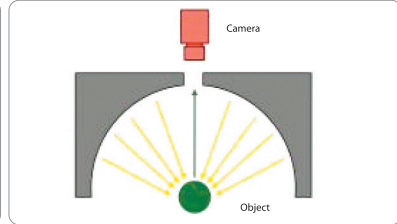

Technical Specification:

- Color Red, Green, Blue and White
- 24V DC Input Power
- Continuous and Strobe Applications
- Compact Size
- Lighting Cable 500mm

Customize Lighting:

- Customize Sizes, Mounting requirements
- Color and Voltage Available
- Consult Technical Sales for More Information

Model	Dimensions (MM)						Color	Voltage / Watt	Current
	ØA	ØB	ØC	D	E	ØF			
IDD-00-045-4-X	55	12	40	23.5	40	40	● ● ● ○ ● ● ● ○	24V / 2.88W 24V / 3.60W	120mA 150mA
IDD-00-075-7-X	80	11	50	42.5	60	60	● ● ● ○ ● ● ● ○	24V / 7.92W 24V / 10.08W	330mA 420mA

Remark: 2 types of white are available- W: Cool White WW: Yellowish White